

8MP LOWLIGHT IR IP H.265 COMPACT FIXED DOME CAMERA



ENV-HDOAF-30R-12

FEATURES

1/3", 8.0 megapixel, progressive scan, CMOS

2.8/4mm Fixed Lens

Smart IR Up to 30m

IP67, POE

ONVIF Profile (S/T)

Triple Stream

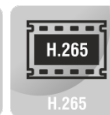

SPECIFICATION

MODEL	Model No.	ENV-HDOAF-30R-12
	Type	8MP Lowlight IR IP H.265 Compact Fixed Dome camera
CAMERA	Image Sensor	1/3", 8.0 megapixel, progressive scan, CMOS
	Lens	2.8mm@F2.0 /4.0mm@F2.0
	Angle of View (H)	112.7° (2.8mm);86.5° (4mm)
	Angle of View (V)	60.1° (2.8mm) ;44.1° (4.0mm)
	Angle of View (O)	146.5° (2.8mm);106.4° (4.0mm)
	Adjustment angle	Pan: 3° ~ 360°, Tilt: 0° ~ 80°, Rotate: 3° ~ 360°
	Shutter	Auto/Manual, 1 ~ 1/100000s
	Minimum Illumination	Colour: 0.05 Lux (2.0, AGC ON);0 Lux with IR
	Day/Night	IR-cut filter with auto switch (ICR)
	S/N	>56dB
	IR Range	Up to 30m (98ft) IR range
	Wavelength	850nm
	IR On/Off Control	Auto/Manual
	Defog	Digital Defog
	WDR	120dB
Warm Light Range	N/A	



8MP LOWLIGHT IR IP H.265 COMPACT FIXED DOME CAMERA



ENV-HDOAF-30R-12

MODEL	Model No.	ENV-HDOAF-30R-12
	Type	8MP Lowlight IR IP H.265 Compact Fixed Dome camera
VIDEO	Video Compression	H.265+, H.265, H.264, MJPEG
	H.264 code profile	Baseline profile, Main profile
	Frame Rate	Main Stream:8MP (3840*2160): Max. 20 fps;5MP(2944*1656): Max. 30 fps; 4MP(2560*1440): Max. 30 fps; 2MP(1920*1080): Max. 30 fps Sub Stream:720P (1280*720): Max. 20 fps Third Stream:4CIF (704*576): Max. 20 fps
	Video Bit Rate	128 Kbps~16 Mbps
	9:16 Corridor Mode	N/A
	OSD	Up to 4 OSDs
	Privacy Mask	Up to 4 areas
	ROI	Up to 2 areas
	White Balance	Auto/Outdoor/Fine Tune/Sodium Lamp/Locked/Auto2
	Digital noise reduction	2D/3D DNR
	Smart IR	Supported
	Flip	Normal/Vertical/Horizontal/180°
	Dewarping	N/A
	HLC	Supported
BLC	Supported	
Motion Detection	Up to 4 areas	
AUDIO	Audio Compression	N/A
	Two-way Audio	N/A
	Audio In	N/A
	Audio Out	N/A
	Suppression	N/A
	Sampling Rate	N/A
	Built-in Mic	N/A
INTERFACE	Alarm Trigger	Intrusion, Human Body Detection, Motion detection, Tampering alarm
	Protocols	IPv4, IGMP, ICMP, ARP, TCP, UDP, DHCP, RTP, RTSP, RTCP, DNS, DDNS, NTP, FTP, UPnP, HTTP, HTTPS, SMTP, SSL, QoS
	Compatibility	ONVIF (Profile S+ Profile T), API
	Network	10/100M Base-TX Ethernet
	Alarm I/O	N/A
	Web Browser	Plug-in required live view: IE9+, Chrome 41 and below, Firefox 52 and below; Plug-in free live view: Chrome 57.0+, Firefox 58.0+, Edge 16+, Safari 11+
	Edge Storage	N/A
	Network Storage	N/A
	Built-in Speaker	N/A
	Alarm Light	N/A
GENERAL	Power Supply	DC 12V±25%, PoE (IEEE 802.3af)
	Power Consumption	Max 5W
	Dimensions (Ø x H)	Φ118×96mm (Φ4.6"×3.8")
	Weight	0.33kg (0.73lb)
	Material	Metal + Plastic
	Working Environment	-30°C ~ 60°C (-22°F ~ 140°F), Humidity: ≤95% RH (non-condensing)
	Storage Environment	-30°C ~ 60°C (-22°F ~ 140°F), Humidity: ≤95% RH (non-condensing)
	Surge Protection	2KV
	Ingress Protection	IP67
	Vandal Resistant	N/A
Reset Button	N/A	



8MP LOWLIGHT IR IP H.265 COMPACT FIXED DOME CAMERA



ENV-HDOAF-30R-12

MODEL	Model No.	ENV-HDOAF-30R-12
	Type	8MP Lowlight IR IP H.265 Compact Fixed Dome camera

Dimension Unit : mm

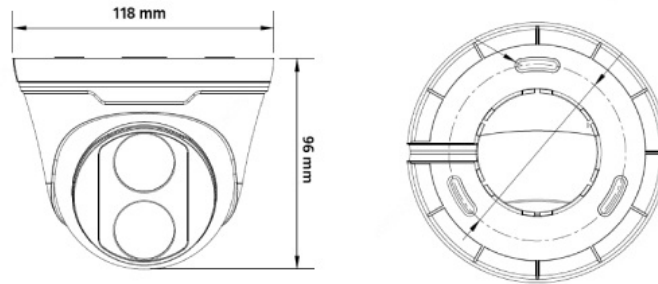

ORDERING INFORMATION

Part Number	Description	Standard Quantity
ENV-HDOAF-30R-12	8MP IR IP H.265 Dome camera with 2.8mm (Optional 4mm) Fixed Lens, POE, WDR and 30M IR support	1

PACKING INFORMATION

Part Number	Packing Mode	Gross weight(Kg)	Dimension(mm)
ENV-HDOAF-30R-12	Carton Box	0.33kg (0.73lb)	Φ118×96mm (Φ4.6"×3.8")

