

3MP FIXED VANDAL DOME CAMERA



ENV-HCV6F-30R-89

FEATURES

2.8 mm Fixed Lens

Smart IR upto 30 m

ONVIF Profile (S,G,T)

Built-in Mic

PoE, IP67, IK10



SPECIFICATION

MODEL	Model No.	ENV-HCV6F-30R-89
	Type	3MP FIXED VANDAL DOME CAMERA
CAMERA	Image Sensor	1/2.7" CMOS Progressive 3.0 MegaPixel
	Day/Night	IR Cut Filter with Auto Switch
	Lens Type	Fixed
	Focal Length	2.8 mm
	Iris	Fixed
	Lens Mount	M12
	Angle of View (H)	100.1°
	Angle Adjustment	Pan 0~330°, Tilt 0~75°, Rotate 0~350°
	Aperture Range	F2.0
	Shutter	1s to 1/100,000s
	Min. Illumination	Color: 0.01 lux @ F2.0, B/W: 0 lux with IR
	AGC	Auto / Manual
	Digital Noise Reduction	3D DNR
	S/N Ratio	52 dB
	Defog	Smart Defog
	WDR	Digital WDR
Smart IR	Up to 30 m	
Wavelength	850 nm	
White LEDs	N/A	

None

★Product specification and availability are subject to change without notice.

3MP FIXED VANDAL DOME CAMERA



ENV-HCV6F-30R-89

MODEL	Model No.	ENV-HCV6F-30R-89
	Type	3MP FIXED VANDAL DOME CAMERA
VIDEO	Max. Resolution	2304X1296
	Video Compression	H.265+, H.265, H.264
	Frame Rate	Main Stream: (2304x1296) @ 20fps, (1920x1080, 1280x720, 704x480, 640x480) @ 30fps, (1920x1080, 1280x720, 704x576, 640x480) @ 25fps Sub Stream: (704x480, 704x240, 640x360, 352x240) @ 30fps, (704x576, 704x288, 640x360, 352x288) @ 25fps
	Stream Settings	I-Frame, PAL/NTSC, Frame Rate (1~30FPS), SVC
	Video Bit Rate	32 kbps ~ 6 Mbps
	Bitrate Type	CBR, VBR
	Image Settings	Brightness, Contrast, Saturation, Hue, Sharpness, Rotation/Mirror, Gain, Exposure, Day/Night
	White Balance	Auto, Semi Auto, Sunshine, Daylight, Warm Light, Filament, Nature Light, Lock WB, Manual
	Corridor Mode	N/A
	HLC	Supported
	BLC	Supported
	OSD	Total 3 regions
	OSD Type	Title, Week, Date, Time, Text with different colors and adaptable sizes (16x16, 32x32, 48x48)
	ROI	N/A
	Privacy Mask	Up to 4 regions
Heatmap	N/A	
Picture Overlay	N/A	
AUDIO	Audio Compression	G.711A, G.711U, ADPCM_D
	Audio Bit Rate	8 kbps ~ 48 kbps
	Audio I/O	N/A
	Audio Voltage	N/A
	Built-in Mic	Supported with noise cancellation
SMART	Behavior Detection	Intrusion (Perimeter), Crossline (Tripwire)
	Intelligent Identification	N/A
	Statistical Analysis	N/A
	Alarm Management	Motion Detection, Tampering (Masking), IP Address Conflict, Pre/Post Alarm Recording, Alarm Recording/Snapshot
INTERFACE	Protocols	TCP/IP, UDP, IPv4, ICMP, HTTP, FTP, DHCP, DNS, DDNS, RTP, RTSP, NTP, UPnP, Unicast, Multicast, Telnet, P2P
	Security	AES Video Encryption, IP Filter, User Authentication (Multiple Privilege Level)
	Compatibility	ONVIF Profile (S, G, T), SDK/API/CGI
	Network	1 x RJ45 10M/100M Self Adaptive Ethernet Port
	Wi-Fi	N/A
	Alarm Interface	N/A
	Alarm Voltage	N/A
	RS485	N/A
	RS232	N/A
	USB	N/A
	Edge Storage	Micro SD card slot, up to 512 GB
	ANR	Supported
	Built-in Speaker	N/A
	Built-in Heater	N/A
	Cable Interface	Cable Free
Remote Connection	≤7	
Web Client	EyeConnect	
Web Language	16	

None

★Product specification and availability are subject to change without notice.

3MP FIXED VANDAL DOME CAMERA



ENV-HCV6F-30R-89

MODEL	Model No.	ENV-HCV6F-30R-89
	Type	3MP FIXED VANDAL DOME CAMERA
GENERAL	Power Supply	12V DC, PoE (IEEE 802.3af)
	Max. Power Consumption	5W (12V DC), 6 W (PoE)
	Working Temperature	-35 °C ~ 65 °C
	Working Humidity	0~95% RH (non-condensing)
	Ingress Protection	IP67
	Vandal Resistant	IK10
	Surge Protection	Supported
	Reset Button	Supported
	Dimensions	Φ120×90 mm
	Net Weight	0.4 Kg

Dimension Unit : mm

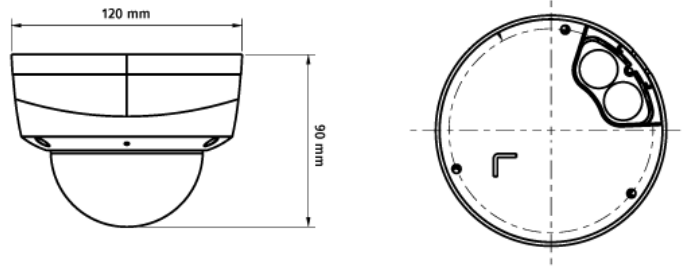

ORDERING INFORMATION

Part Number	Description	Standard Quantity
ENV-HCV6F-30R-89	3MP IR IP H.265 Vandal Proof Compact Dome camera with 2.8mm Fixed Lens, PoE, SD card slot, Built-in 1 Mic and 30m IR support	

PACKING INFORMATION

Part Number	Packing Mode	Gross weight(Kg)	Dimension(mm)
ENV-HCV6F-30R-89	Carton Box	0.6	138×138×110

None

★Product specification and availability are subject to change without notice.