

Key Switch

Secnor NAC-9101EB Key Switch has a standard structure made up of Stainless Steel Panel and a Key.

Application

Office areas, schools, communities, office buildings, hotels, shopping malls, shops, public service places, etc.

Features

- 2NO/2NC/2COM
- Standard Key: 2 PCS
- 1.8mm thick stainless steel panel
- Optional Backbox of size 86Lx86Wx28H(mm) available



Technical Parameters

| | |
|-----------------------|---------------------------------------|
| Dimensions | 86Lx86Wx30H(mm) |
| Standard Structure | 1.8mm thick 304 stainless steel panel |
| Power Supply | DC 12V |
| Output Contact | 2NO/2NC/2COM |
| Mechanical Life | 500000 |
| Operating Temperature | -20°C~+55°C (-4°F~131°F) |
| Operating Humidity | 0-95% (RH) |
| Weight | 0.187Kg |

Dimensions:

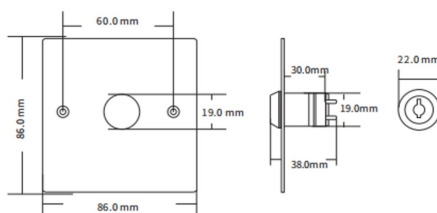

Ordering Information

| Part Number | Description |
|-------------|------------------------------|
| NAC-9101EB | Key Switch |
| NAC-9111BB | Metal Backbox For NAC-9101EB |