

5MP FIXED VANDAL DOME CAMERA



ENV-HCV8F-30R-91

FEATURES

2.8 mm Fixed Lens

Smart IR up to 30 m

ONVIF Profile (S, G, T)

Built-in Mic

PoE, IP67, IK10

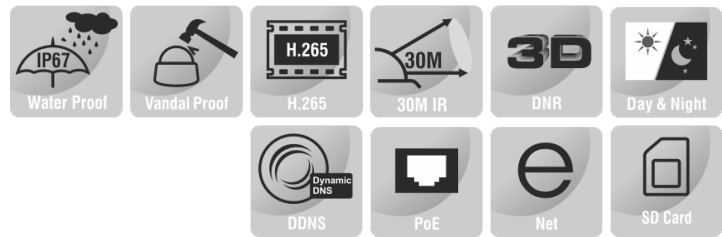

SPECIFICATION

MODEL	Model No.	ENV-HCV8F-30R-91
CAMERA	Type	5MP FIXED VANDAL DOME CAMERA
	Image Sensor	1/2.8" CMOS Progressive 5.0 MegaPixel
	Day/Night	IR Cut Filter with Auto Switch
	Lens Type	Fixed
	Focal Length	2.8 mm
	Iris	Fixed
	Lens Mount	M12
	Angle of View (H)	94.7°
	Angle of View (V)	71.2°
	Angle Adjustment	Pan 0~330°, Tilt 0~75°, Rotate 0~350°
	Aperture Range	F1.6
	Shutter	1s to 1/100,000s
	Min. Illumination	Color: 0.001 Lux @ F1.6, B/W: 0 lux with IR
	AGC	Auto / Manual
	Digital Noise Reduction	3D DNR
	S/N Ratio	≥60 dB
	Defog	Smart Defog
	WDR	120 dB
	Smart IR	Up to 30 m
Wavelength	850 nm	
White LEDs	N/A	

5MP FIXED VANDAL DOME CAMERA



ENV-HCV8F-30R-91

MODEL	Model No.	ENV-HCV8F-30R-91
	Type	5MP FIXED VANDAL DOME CAMERA
VIDEO	Max. Resolution	2592x1944
	Video Compression	H.265+, H.265, H.264
	Frame Rate	Main Stream: : (2592x1944, 2592x1520) @ 20fps, (2560x1440) @ 25fps, (2304x1296, 1920x1080, 1280x720) @ 25/30fps Sub Stream: (704x480, 704x240, 640x360, 352x240) @ 30fps, (704x576, 704x288, 640x360, 352x288) @ 25 fps
	Stream Settings	I-Frame, PAL/NTSC, Frame Rate (1~30FPS), SVC
	Video Bit Rate	32 kbps ~ 6 Mbps
	Bitrate Type	CBR, VBR
	Image Settings	Brightness, Contrast, Saturation, Hue, Sharpness, Rotation/Mirror, Gain, Exposure, Day/Night
	White Balance	Auto, Semi Auto, Sunshine, Daylight, Warm Light, Filament, Nature Light, Lock WB, Manual
	Corridor Mode	N/A
	HLC	Supported
	BLC	Supported
	OSD	Total 1 regions
	OSD Type	Title, Week, Date, Time, Text with different colors and adaptable sizes (16x16, 32x32, 48x48)
	ROI	Up to 8 regions
	Privacy Mask	Up to 4 regions
AUDIO	Audio Compression	G.711A, G.711U, ADPCM_D
	Audio Bit Rate	8 kbps ~ 48 kbps
	Audio I/O	N/A
	Built-in Mic	Supported with noise cancellation
SMART	Behavior Detection	Intrusion (Perimeter), Crossline (Tripwire)
	Intelligent Identification	N/A
	Statistical Analysis	N/A
	Alarm Management	Motion Detection, Tampering (Masking), IP Address Conflict
	Alarm Notification	HTTP, FTP, SD Card & Alarm Out (Event Notification / Recording / Snapshot upload through HTTP, FTP, & SD Card)
INTERFACE	Protocols	TCP/IP, UDP, ICMP, HTTP, FTP, DHCP, DNS, DDNS, RTP, RTSP, RTCP, NTP, UPnP, P2P
	Security	AES Video Encryption, IP Filter, User Authentication (Multiple Privilege Level)
	Compatibility	ONVIF Profile (S, G, T), SDK/API/CGI
	Network	1 x RJ45 10M/100M Self Adaptive Ethernet Port
	Alarm Interface	N/A
	Serial Interface	N/A
	USB	N/A
	Edge Storage	Micro SD card slot, up to 512 GB
	ANR	Supported
	Cable Interface	Cable Free
	Max. User Access	32
	Remote Connection	≤7
	Client Application	EyeConnect
	Web Language	15
GENERAL	Power Supply	12V DC, PoE (802.3af)
	Max. Power Consumption	6 W (12V DC), 8 W (PoE)
	Working Temperature	-40 °C ~ 60 °C
	Working Humidity	0~95% RH (non-condensing)
	Ingress Protection	IP67
	Vandal Resistant	IK10
	Surge Protection	TVS4000V
	Reset Button	Supported
	Dimensions	Φ120x90 mm
	Net Weight	0.4 Kg

5MP FIXED VANDAL DOME CAMERA



ENV-HCV8F-30R-91

MODEL	Model No.	ENV-HCV8F-30R-91
	Type	5MP FIXED VANDAL DOME CAMERA

Dimension Unit : mm

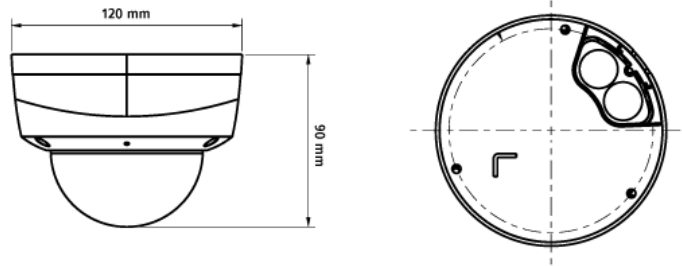

ORDERING INFORMATION

Part Number	Description	Standard Quantity
ENV-HCV8F-30R-91	5MP Low light IR IP H.265 Vandal Proof Compact Dome camera with 2.8mm Fixed Lens, PoE,WDR, SD card slot, Built-in Mic and 30M IR support	1
ENB-BTDV66	Eyenor Pole Mount Bracket for Dome Camera	1
ENB-BTDH66	Eyenor Outer Corner Bracket for Dome Camera	1
ENB-BTDJ66	Eyenor Junction Box for Dome Camera	1
ENB-BTEW65	Eyenor Wall Mount for Lite Series Turret Camera, Mini Dome (Plastic)	1
ENB-BTDP66	Eyenor Pendant Mount for Dome Camera	1

PACKING INFORMATION

Part Number	Packing Mode	Gross weight(Kg)	Dimension(mm)
ENV-HCV8F-30R-91	Carton Box	0.6	-