

# 8MP FIXED VANDAL DOME CAMERA



ENC-HVDAF-30R-94

## FEATURES

Starlight Illumination
2.8 mm Fixed Lens
Smart IR up to 30 m
ONVIF Profile (S, G, T)
Triple Stream
Audio and Alarm Support
PoE, IP67, IK10

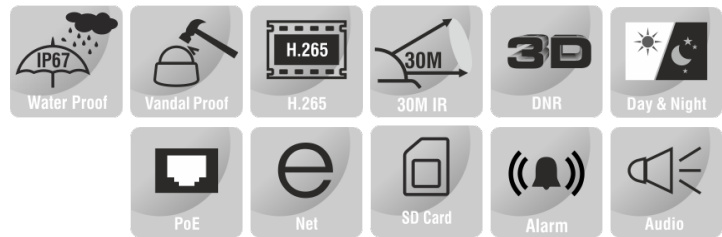

## SPECIFICATION

MODEL		Model No.	ENC-HVDAF-30R-94
		Type	8MP FIXED VANDAL DOME CAMERA
CAMERA	Image Sensor		1/2.8" CMOS Progressive 8.0 MegaPixel
	Day/Night		IR Cut Filter with Auto Switch
	Lens Type		Fixed
	Focal Length		2.8 mm
	Focus		Fixed
	Iris		Fixed
	Lens Mount		M12
	Angle of View (H)		96°
	Angle of View (V)		72.2°
	Angle Adjustment		Pan 0~330°, Tilt 0~75°, Rotate 0~350°
	Aperture Range		F1.6
	Shutter		1s to 1/100,000s
	Min. Illumination		Color: 0.003 lux @ F1.6, B/W: 0 lux with IR
	AGC		Auto / Manual
	Digital Noise Reduction		3D DNR
	S/N Ratio		55 dB
Defog		Smart Defog	
WDR		120 dB	
Smart IR		Up to 30 m	
Wavelength		850 nm	
White LEDs		N/A	

None

★Product specification and availability are subject to change without notice.

# 8MP FIXED VANDAL DOME CAMERA



## ENC-HVDAF-30R-94

<b>MODEL</b>	<b>Model No.</b>	<b>ENC-HVDAF-30R-94</b>
	<b>Type</b>	8MP FIXED VANDAL DOME CAMERA
<b>VIDEO</b>	<b>Max. Resolution</b>	3840x2160
	<b>Video Compression</b>	H.265+, H.265, H.264, MJPEG
	<b>Frame Rate</b>	Main Stream: (3840x2160, 3072x2048) @ 25/30fps, (2560x1440, 2304x1296, 1920x1080, 1280x720) @ 25/30fps Sub Stream: (704x480, 704x240, 640x480, 352x240) @ 30f fps, (704x576, 704x288, 640x480, 352x288) @ 25fps Third Stream: (704x480, 704x240, 640x360, 352x240) @ 30fps, (704x576, 704x288, 640x480, 352x288) @ 25fps
	<b>Stream Settings</b>	i-Frame, PAL/NTSC, Frame Rate (1~30FPS), EIS, SVC
	<b>Video Bit Rate</b>	32 kbps ~ 16 Mbps
	<b>Bitrate Type</b>	CBR, VBR
	<b>Image Settings</b>	Brightness, Contrast, Saturation, Hue, Sharpness, Rotation/Mirror, Gain, Exposure, Day/Night
	<b>White Balance</b>	Auto, Semi Auto, Sunshine, Daylight, Warm Light, Filament, Nature Light, Lock WB, Manual
	<b>Corridor Mode</b>	Supported
	<b>HLC</b>	Supported
	<b>BLC</b>	Supported
	<b>OSD</b>	Total 8 regions
	<b>OSD Type</b>	Title, Week, Date, Time, Text with different colors and adaptable sizes (16x16, 24x24, 32x32, 48x48, 64x64, 96x96), Image overlay
	<b>ROI</b>	Up to 8 regions
<b>Privacy Mask</b>	Up to 4 regions	
<b>Heatmap</b>	Supported	
<b>AUDIO</b>	<b>Audio Compression</b>	G.711A, G.711U, ADPCM_D, AAC_LC
	<b>Audio Bit Rate</b>	8 kbps ~ 48 kbps
	<b>Audio I/O</b>	1/1
	<b>Audio Voltage</b>	Input: Level 5V, Input Impedance 1500 ohms Output: Level 3V, Output Impedance 100 ohms
	<b>Built-in Mic</b>	Supported with noise cancellation
<b>SMART</b>	<b>Behavior Detection</b>	Intrusion (Perimeter), Crossline (Tripwire), Double Crossline (Double Tripwire)
	<b>Intelligent Identification</b>	Loitering, Running, Abandoned Object (Object Left), Missing Object (Object Lost), Parking
	<b>Statistical Analysis</b>	Face Detection (Capture), People Counting, Crowd Detection, On Duty Detection, Helmet Detection, Human & Vehicle Classification, Abnormal Video & Audio Detection
	<b>Alarm Management</b>	Motion Detection, Tampering (Masking), Input & Output Event, IP & MAC Address Conflict, Disk Alarm (Full & R/W Error), FTP Server Exception, Abnormal Voltage, Pre/Post Alarm Recording, Alarm Recording/Snapshot
<b>INTERFACE</b>	<b>Protocols</b>	TCP/IP, UDP, IPv4, IPv6, ICMP, HTTP, HTTPS, FTP, NFS, DHCP, DNS, DDNS, RTP, RTSP, RTCP, RTMP, PPPoE, NTP, UPnP, SMTP (SSL/TLS), IGMP, 802.1X, QoS (DSCP), Unicast, Multicast, ARP, SNMP, SSL, Telnet, SFTP (SSH), P2P
	<b>Security</b>	AES Video Encryption, IP Filter, User Authentication (Multiple Privilege Level), 802.1X Authentication (EAP-MD5), HTTPS Authentication, Digest Authentication, User Access Log
	<b>Compatibility</b>	ONVIF Profile (S, G, T), SDK/API/CGI
	<b>Network</b>	1 x RJ45 10M/100M Self Adaptive Ethernet Port
	<b>Wi-Fi</b>	N/A
	<b>Alarm Interface</b>	1 Input / 1 Output
	<b>Alarm Voltage</b>	Input (switch type) , Output (3.3V-12V, 10 ohm)
	<b>Serial Interface</b>	N/A
	<b>Edge Storage</b>	MicroSD card slot, up to 512 GB
	<b>ANR</b>	Supported
	<b>Built-in Speaker</b>	N/A
	<b>Cable Interface</b>	Cable Free
<b>Remote Connection</b>	≤8	
<b>Web Client</b>	EyeConnect	
<b>Web Language</b>	15	

None

★Product specification and availability are subject to change without notice.

# 8MP FIXED VANDAL DOME CAMERA



## ENC-HVDAF-30R-94

MODEL	Model No.	ENC-HVDAF-30R-94
	Type	8MP FIXED VANDAL DOME CAMERA
GENERAL	Power Supply	12V DC, PoE (IEEE 802.3af)
	Max. Power Consumption	5 W (12V DC), 6 W (PoE)
	Working Temperature	-40 °C ~ 65 °C
	Working Humidity	0-95% RH (non-condensing)
	Ingress Protection	IP67
	Vandal Resistant	IK10
	Surge Protection	Supported
	Reset Button	Supported
	Dimensions	Φ120×90 mm
	Net Weight	0.45 Kg

Dimension Unit : mm

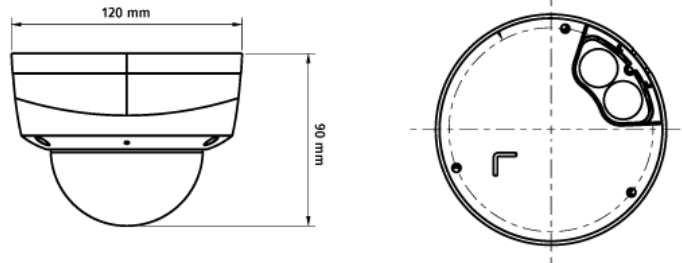

### ORDERING INFORMATION

Part Number	Description	Standard Quantity
ENC-HVDAF-30R-94	8MP Starlight IR IP Vandal Proof Dome Camera with 2.8mm Fixed Lens, PoE, WDR, SD Card Slot, Built-in Mic, Smart Analytics and 30m IR Support	1

### PACKING INFORMATION

Part Number	Packing Mode	Gross weight(Kg)	Dimension(mm)
ENC-HVDAF-30R-94	Carton Box	0.65	138×138×110

None

★Product specification and availability are subject to change without notice.