

# IP Based Power Amplifier 130W



## DESCRIPTION

NVS-IP100006AM is an IP based amplifier, a kind of fully networking analogue to digital signal processor supporting with 10/100Mbps adaptive TCP/IP Network transmission protocol. It is a built-in high-efficiency digital amplifier with 100V constant voltage output. This device Support offline broadcasting, automatically enabling the local broadcasting even the network got interrupted. It is integrated with standard RJ45 network interface, accessible to the system when Ethernet is available, supporting crossing network segment and router.

## FEATURES

- ⦿ Compact 1U rack design, both flexible and durable
- ⦿ Built-in digital Class-D 130W amplifier suitable for 100V powered loudspeakers
- ⦿ Multiple status indicator lights on the front panel for easier maintenance
- ⦿ Comprehensive protection circuit for overload, overheating and lightning
- ⦿ Large-capacity storage for uploading and remotely updating timed tasks and alarm files
- ⦿ SIP protocol compatibility for easy integration with mainstream VoIP systems (Yeastar, Asterisk, Cisco, etc.)
- ⦿ Supports offline broadcasting independently of a server
- ⦿ Receives live voice announcements from third-party VoIP systems or NORDEN's centralized management software
- ⦿ Relay I/O port for connecting with fire alarm systems

Specifications	
<b>Model</b>	<b>NVS-IP100006AM</b>
Power Supply	AC 100V-240V, 50/60Hz
Rated Power Output	130W
Power Consumption	≤160W
Audio Codec	MP3, PCM, ADPCM, G.711 A-law, G.711 μ-law, G.729
Signal to Noise Ratio	≥84dB
Audio Sampling & Bit Rate	8kHz~44.1kHz, 16bit, 8kbps~320kbps
Total Harmonic Distortion	≤0.5% at 1kHz, 1/2 rated output
Frequency response	60Hz~16kHz
Network Interface	10BASE-T/100BASE-TX RJ45
Network Protocol	SIP, FTP, HTTP, RTP, TCP/IP, UDP, ARP, ICMP, IGMP
Configuration Method	Web Interface or DevConfig Tool
Mounting Method	1U Rack-Mounted

## NVS-IP100006AM

# IP Based Power Amplifier 130W

Installation Environment	Dry Indoor Locations Only
Operating Temperature	0°C~+45°C (32°F~113°F)
Storage Temperature	-20°C~+55°C (-4°F~131°F)
Operating Humidity	≤90% RH (Non-Condensing)
Heat Dissipation	Intelligent Temperature Control, Forced Air Cooling
Protection	Over-Current Protection, Short-Circuit Protection, Overload Protection, Thermal Protection, Lightning Protection, Surge Protection
Front Panel Material	Surface-Treated Steel Plate
Housing Material	Surface-Treated Steel Plate
Colour	Black
Product Dimension	440x300x44 mm
Product Weight	3.5 Kg
Packaging	Carton Box
Packed Dimension	580x350x140 mm
Packed Weight	4.6 Kg

## FRONT PANEL

② **STATUS:**

Green light normally on when online ,red light normally on when offline.

① **POWER:**

Red light normally on when the amplifier is powered on.



③ **SIGNAL:**

No light when there is no signal input ,green light normally on when there is signal input.

⑤ **PROTECT:**

Yellow light normally on when the amplifier is malfunctioning.

④ **CLIP:**

Red light normally on when the amplifier is overloaded.

# IP Based Power Amplifier 130W

## REAR PANEL

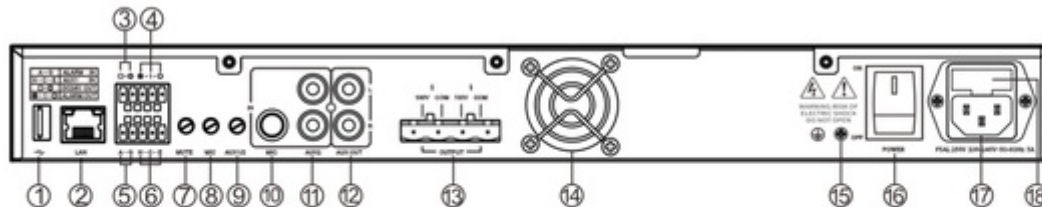

① **USB port** : Reserved.

② **Network port** : To connect to Ethernet switch.

③ **DC 24V Power Relay Output** :  
2-Pin pluggable terminal block (3.81mm Pitch, AWG 26-16), normally open (NO) dry contact with DC 24V power output.

④ **Relay Output** :  
3-Pin pluggable terminal block (3.81mm Pitch, AWG 26-16), normally open (NO) or normally closed (NC) dry contact

⑤ **Relay Input** :  
2-Pin pluggable terminal block (3.81mm Pitch, AWG 26-16), normally open (NO) dry contact;

⑥ **Aux Input 01:**  
3-Pin pluggable terminal block(3.81mm Pitch, AWG 26-16) (Balanced, Sensitivity/ Impedance: 500mV/10kΩ);

⑦ **MUTE Knob:**  
MUTE depth adjustment knob, when the MIC input signals, it'll automatically MUTE AUX1 and AUX2, clockwise rotation will increase the MUTE depth, anticlockwise rotation will decrease the MUTE depth;

⑧ **MIC Knob** :  
Adjust the MIC input volume, clockwise rotation will increase the volume, anticlockwise rotation will decrease the volume;

⑨ **AUX1/2 Knob** :  
Adjust the Line input volume ,clockwise rotation will increase the volume, anticlockwise rotation will decrease the volume.

⑩ **Mic Input:**  
1/4-inch (6.35mm) TRS Jack (Unbalanced, Sensitivity/Impedance: 100mV/600Ω)

⑪ **Aux Input 02:**  
Dual RCA Jacks (Unbalanced, Sensitivity/ Impedance: 500mV/10kΩ)

⑫ **Aux Output:**  
Dual RCA Jacks.

⑬ **Speaker Output 01/02 (100V):**  
2-Pin Pluggable Terminal Block (7.62mm Pitch, AWG 28-12), connecting and driving 100V constant-voltage passive speakers;

⑭ **Cooling Fan**

⑮ **Ground Terminal**

⑯ **Power Switch**

⑰ **Power Input Interface**

⑱ **Insurance Block**

# IP Based Power Amplifier 130W

## CONNECTION DIAGRAM

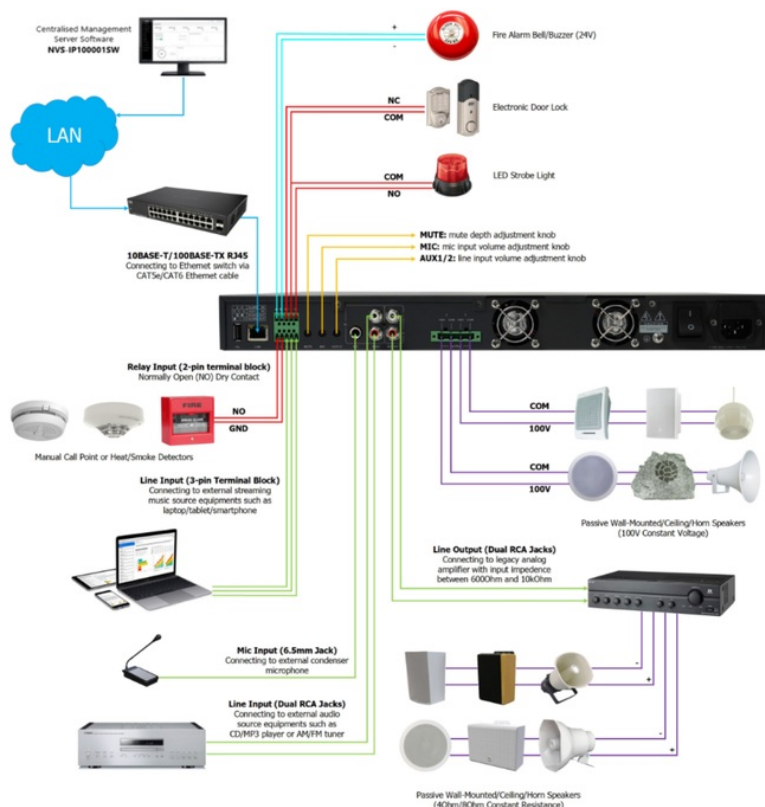

## DIMENSION

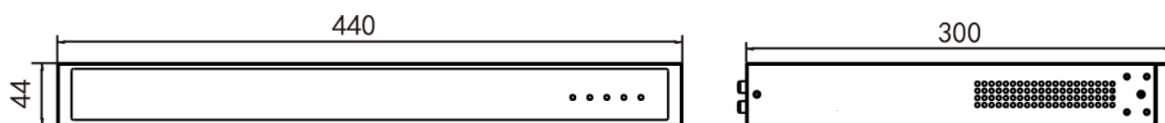

## ORDERING INFORMATION

Part Number	Description	Standard Quantity
NVS-IP100006AM	IP Based Power Amplifier 130W	01

# IP Based Power Amplifier 130W

## ACCESSORIES INFORMATION

Description	Standard Quantity
5-Pin Pluggable Terminal Block Connector (3.81mm Pitch, AWG 26-16)	02
4-Pin Pluggable Terminal Block Connector (7.62mm Pitch, AWG 28-12)	01
Flat Head Screw	08
3M Floor Pad	04
Rack Mounting Bracket	02
Quick Installation Guide	01
Quality Certificate	01
Warranty Card	01
Power Cord	01