

5MP FIXED VANDAL DOME CAMERA



ENC-HVD8F-30R-92

FEATURES

Starlight Illumination
2.8 mm Fixed Lens
Smart IR up to 30 m
ONVIF Profile (S, G, T)
Triple Stream
Audio and Alarm Support
PoE, IP66



SPECIFICATION

MODEL	Model No.	ENC-HVD8F-30R-92
	Type	5MP FIXED VANDAL DOME CAMERA
CAMERA	Image Sensor	1/2.8" CMOS Progressive 5.0 MegaPixel
	Day / Night	IR Cut Filter with Auto Switch
	Lens Type	Fixed
	Focal Length	2.8 mm
	Focus	Fixed
	Iris	Fixed
	Lens Mount	M12
	Angle of View (H)	94.7°
	Angle of View (V)	71.2°
	Digital Zoom	16x
	Angle Adjustment	Bracket; Pan: 0~330°, Tilt: 0~75°, Rotate: 0~350°
	Aperture Range	F1.6
	Shutter	1s to 1/100,000s, Auto / Manual
	Min. Illumination	Color: 0.001 lux @ F1.6, B/W: 0 lux with IR
	AGC	Auto / Manual
	Digital Noise Reduction	3D DNR
	S/N Ratio	≥60 dB
Defog	Smart Defog	
WDR	120 dB	
Smart IR	Up to 30 m	
Wavelength	850 nm	
White LEDs	N/A	

5MP FIXED VANDAL DOME CAMERA



ENC-HVD8F-30R-92

MODEL		Model No.	ENC-HVD8F-30R-92
VIDEO	Type	5MP FIXED VANDAL DOME CAMERA	
	Max. Resolution	2592x1944	
	Video Compression	H.265+, H.265, H.264	
	Frame Rate	Main Stream: (2592x1944) @ 20fps, (2592x1520, 2560x1440) @ 25fps, (2304x1296, 1920x1080, 1280x720) @ 25/30fps Sub Stream: (704x480, 704x240, 640x360, 352x240) @ 30fps, (704x576, 704x288, 640x360, 352x288) @ 25fps Third Stream: (704x480, 704x240, 640x360, 352x240) @ 5fps, (704x576, 704x288, 640x360, 352x288) @ 5fps	
	Stream Settings	i-Frame, PAL/NTSC, Frame Rate (1~30FPS), EIS, SVC	
	Video Bit Rate	32 kbps ~ 6 Mbps	
	Bitrate Type	CBR, VBR	
	Image Settings	Brightness, Contrast, Saturation, Hue, Sharpness, Rotation/Mirror, Gain, Exposure, Day/Night	
	White Balance	Auto, Semi Auto, Sunshine, Daylight, Warm Light, Filament, Nature Light, Lock WB, Manual	
	HLC	Supported	
	BLC	Supported	
	OSD	Total 1 regions	
	OSD Type	Title, Week, Date, Time, Text with different colors and adaptable sizes (16x16, 32x32, 48x48, 64x64)	
	ROI	Up to 8 regions	
	Privacy Mask	Up to 4 regions	
	AUDIO	Audio Compression	G.711A, G.711U, ADPCM_D
Audio Bit Rate		8 kbps ~ 48 kbps	
Audio I/O		1/1	
Built-in Mic		Supported with noise cancellation	
SMART	Behavior Detection	Intrusion (Perimeter), Crossline (Tripwire)	
	Intelligent Identification	N/A	
	Statistical Analysis	N/A	
	Alarm Management	Motion Detection, Mask Alarm, IP Address Conflict	
INTERFACE	Alarm Notification	HTTP, FTP, SD card & Alarm Out (Event Notification/ Recording/ Snapshot upload through HTTP, FTP & SD card)	
	Protocols	TCP/IP, UDP, IPv4, ICMP, HTTP, DHCP, DNS, DDNS, RTSP, RTMP, NTP, FTP, UPnP, P2P	
	Security	AES Video Encryption, IP Filter, User Authentication (Multiple Privilege Level)	
	Compatibility	ONVIF Profile (S, G, T), SDK/API/CGI	
	Network	1 x RJ45 10M/100M Self Adaptive Ethernet Port	
	Wi-Fi	N/A	
	Alarm Interface	1 Input / 1 Output	
	Serial Interface	N/A	
	USB	N/A	
	Edge Storage	Built-in MicroSD card slot, up to 512 GB	
	ANR	Supported	
	Built-in Speaker	N/A	
	Built-in Heater	N/A	
	Cable Interface	Cable Free	
	Max. User access	32	
	Client Application	EyeConnect	
Web Language	16		
GENERAL	Power Supply	DC 12V, PoE (802.3af)	
	Max. Power Consumption	4 W (12V DC), 6 W (PoE)	
	Working Temperature	-40 °C ~ 60 °C	
	Working Humidity	0-95% RH (non-condensing)	
	Ingress Protection	IP66	
	Vandal Resistant	IK10 (Housing)	
	Surge Protection	TVS4000V	
	Reset Button	Supported	
	Dimensions	Φ120 x 90mm	
	Net Weight	0.41 Kg	

5MP FIXED VANDAL DOME CAMERA



ENC-HVD8F-30R-92

MODEL	Model No.	ENC-HVD8F-30R-92
	Type	5MP FIXED VANDAL DOME CAMERA

Dimension Unit : mm

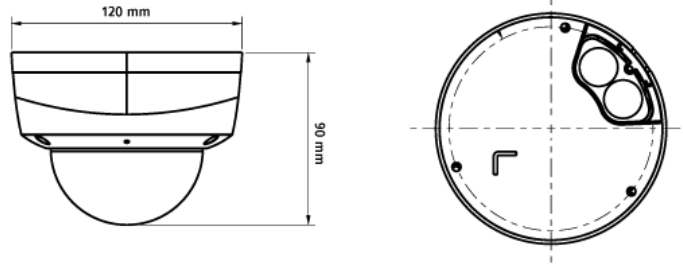

ORDERING INFORMATION

Part Number	Description	Standard Quantity
ENC-HVD8F-30R-92	5MP Starlight IR IP H.265 Vandal Proof Dome Camera with 2.8mm Fixed Lens, PoE, WDR, SD Card Slot, Built-in Mic and 30m IR Support	1
ENB-BTDV66	Eyenor Pole Mount Bracket for Dome Camera	1
ENB-BTDH66	Eyenor Outer Corner Bracket for Dome Camera	1
ENB-BTDJ66	Eyenor Junction Box for Dome Camera	1
ENB-BTEW65	Eyenor Wall Mount for Lite Series Turret Camera, Mini Dome (Plastic)	1
ENB-BTDW66	Eyenor Wall Mount Bracket for Fixed Lens Dome Camera (Metal)	1
ENB-BTDP66	Eyenor Pendant Mount for Dome Camera	1

PACKING INFORMATION

Part Number	Packing Mode	Gross weight(Kg)	Dimension(mm)
ENC-HVD8F-30R-92	Carton Box	-	-