

# 5MP FIXED VANDAL DOME CAMERA



ENC-HVD8F-30R-92

## FEATURES

Starlight Illumination
2.8 mm Fixed Lens
Smart IR up to 30 m
ONVIF Profile (S, G, T)
Triple Stream
Audio and Alarm Support
PoE, IP66



## SPECIFICATION

MODEL	Model No.	ENC-HVD8F-30R-92
	Type	5MP FIXED VANDAL DOME CAMERA
CAMERA	Image Sensor	1/2.8" CMOS Progressive 5.0 MegaPixel
	Day / Night	IR Cut Filter with Auto Switch
	Lens Type	Fixed
	Focal Length	2.8 mm
	Focus	Fixed
	Iris	Fixed
	Lens Mount	M12
	Angle of View (H)	94.7°
	Angle of View (V)	71.2°
	Digital Zoom	16x
	Angle Adjustment	Bracket; Pan: 0~330°, Tilt: 0~75°, Rotate: 0~350°
	Aperture Range	F1.6
	Shutter	1s to 1/100,000s, Auto / Manual
	Min. Illumination	Color: 0.001 lux @ F1.6, B/W: 0 lux with IR
	AGC	Auto / Manual
Digital Noise Reduction	3D DNR	
S/N Ratio	≥60 dB	
Defog	Smart Defog	
WDR	120 dB	
Smart IR	Up to 30 m	
Wavelength	850 nm	

# 5MP FIXED VANDAL DOME CAMERA



## ENC-HVD8F-30R-92

MODEL	Model No.	ENC-HVD8F-30R-92
	Type	5MP FIXED VANDAL DOME CAMERA
VIDEO	Max. Resolution	2592x1944
	Video Compression	H.265+, H.265, H.264
	Frame Rate	Main Stream: (2592x1944) @ 20fps, (2592x1520, 2560x1440) @ 25fps, (2304x1296, 1920x1080, 1280x720) @ 25/30fps Sub Stream: (704x480, 704x240, 640x360, 352x240) @ 30fps, (704x576, 704x288, 640x360, 352x288) @ 25fps Third Stream: (704x480, 704x240, 640x360, 352x240) @ 5fps, (704x576, 704x288, 640x360, 352x288) @ 5fps
	Stream Settings	i-Frame, PAL/NTSC, Frame Rate (1~30FPS), EIS, SVC
	Video Bit Rate	32 kbps ~ 6 Mbps
	Bitrate Type	CBR, VBR
	Image Settings	Brightness, Contrast, Saturation, Hue, Sharpness, Rotation/Mirror, Gain, Exposure, Day/Night
	White Balance	Auto, Semi Auto, Sunshine, Daylight, Warm Light, Filament, Nature Light, Lock WB, Manual
	HLC	Supported
	BLC	Supported
	OSD	Total 1 regions
	OSD Type	Title, Week, Date, Time, Text with different colors and adaptable sizes (16x16, 32x32, 48x48, 64x64)
	ROI	Up to 8 regions
	Privacy Mask	Up to 4 regions
AUDIO	Audio Compression	G.711A, G.711U, ADPCM_D
	Audio Bit Rate	8 kbps ~ 48 kbps
	Audio I/O	1/1
	Built-in Mic	Supported with noise cancellation
SMART	Behavior Detection	Intrusion (Perimeter), Crossline (Tripwire)
	Intelligent Identification	N/A
	Statistical Analysis	N/A
	Alarm Management	Motion Detection, Mask Alarm, IP Address Conflict
INTERFACE	Alarm Notification	HTTP, FTP, SD card & Alarm Out (Event Notification/ Recording/ Snapshot upload through HTTP, FTP & SD card)
	Protocols	TCP/IP, UDP, IPv4, ICMP, HTTP, DHCP, DNS, DDNS, RTSP, RTMP, NTP, FTP, UPnP, P2P
	Security	AES Video Encryption, IP Filter, User Authentication (Multiple Privilege Level)
	Compatibility	ONVIF Profile (S, G, T), SDK/API/CGI
	Network	1 x RJ45 10M/100M Self Adaptive Ethernet Port
	Alarm Interface	1 Input / 1 Output
	Edge Storage	Built-in MicroSD card slot, up to 512 GB
	ANR	Supported
	Cable Interface	Cable Free
	Max. User access	32
GENERAL	Client Application	EyeConnect
	Web Language	15
	Power Supply	DC 12V, PoE (802.3af)
	Max. Power Consumption	4 W (12V DC), 6 W (PoE)
	Working Temperature	-40 °C ~ 60 °C
	Working Humidity	0-95% RH (non-condensing)
	Ingress Protection	IP66
	Vandal Resistant	IK10 (Housing)
	Surge Protection	TVS4000V
	Reset Button	Supported
Dimensions	Φ120 x 90mm	
Net Weight	0.41 Kg	

# 5MP FIXED VANDAL DOME CAMERA



ENC-HVD8F-30R-92

MODEL	Model No.	ENC-HVD8F-30R-92
	Type	5MP FIXED VANDAL DOME CAMERA

Dimension Unit : mm

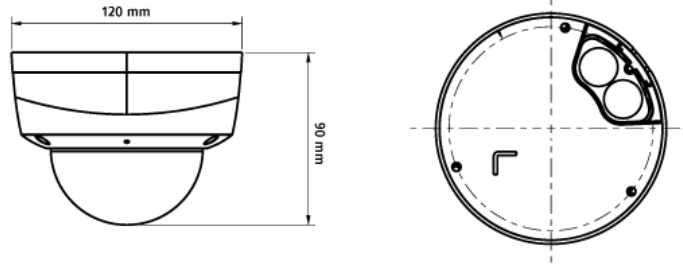

## ORDERING INFORMATION

Part Number	Description	Standard Quantity
ENC-HVD8F-30R-92	5MP Starlight IR IP H.265 Vandal Proof Dome Camera with 2.8mm Fixed Lens, PoE, WDR, SD Card Slot, Built-in Mic and 30m IR Support	1
ENB-BTDV66	Eyenor Pole Mount Bracket for Dome Camera	1
ENB-BTDH66	Eyenor Outer Corner Bracket for Dome Camera	1
ENB-BTDJ66	Eyenor Junction Box for Dome Camera	1
ENB-BTEW65	Eyenor Wall Mount for Lite Series Turret Camera, Mini Dome (Plastic)	1
ENB-BTDW66	Eyenor Wall Mount Bracket for Fixed Lens Dome Camera (Metal)	1
ENB-BTDP66	Eyenor Pendant Mount for Dome Camera	1

## PACKING INFORMATION

Part Number	Packing Mode	Gross weight(Kg)	Dimension(mm)
ENC-HVD8F-30R-92	Carton Box	-	-