

NVS-IP100040SP



# 360 Tune Cast Smart Speaker

IP Speaker



## DESCRIPTION

The NVS-IP100040SP is a 360 Tune Cast Smart Speaker that is combined with audio and wireless communication. Using sound intelligence equalization algorithms, the built-in 4-channel independent speakers provide a 360° omnidirectional sound generating system that ensures balanced coverage at a reasonable sound pressure level. It has a 3.5mm line input interface for external audio input from several sources, such as a computer or mobile phone. The built-in EQ adjustment and preset sound styles that can be specifically tuned to the live environment.

## FEATURES

- Built-in 4 channels amplifier output
- Bluetooth 5.0, allows Bluetooth devices to connect and play audio
- All-in-one design, ceiling or bracket mounting
- Built-in wireless microphone receiver module
- Supports wireless microphone
- Supports optional network broadcast module
- Supports standard SIP protocol for easy integration with mainstream SIP PBX like Yeaster, Asterisk, Cisco etc)

Specifications	
Model	NVS-IP100040SP
Frequency Response	53Hz-18KHz (±3dB)
Sensitivity(1m/1w)	95dB
Audio Sampling Rate	8kHz~44KHz, 16 bit
Network Interface	10BASE-T / 100BASE- TX RJ45
Network Protocol	TCP/IP, UDP, ARP, ICMP, IGMP
Operating Temperature	-10°C~+55°C
Operating Humidity	10%~90% RH non-condensing
Output Power	4x10W
Power Supply	AC100~240V,50/60Hz
Standby Power Consumption	≤4W
Weight	7.5Kg
Dimension	402x402x208mm

# 360 Tune Cast Smart Speaker

## FRONT PANEL

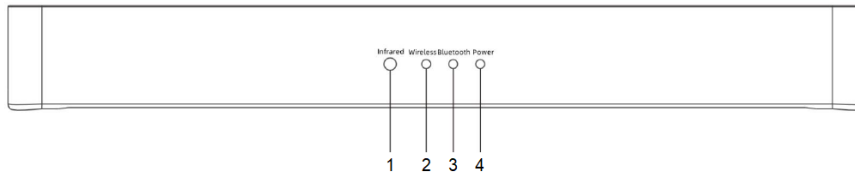

1. Infrared indicator light
2. Wireless indicator light: The indicator light is off when the wireless is not connected, and the orange indicator is steady on when the wireless is successfully connected
3. Bluetooth indicator light: The indicator is off when the Bluetooth is not connected, and the blue indicator is steady on after the connection is successful.
4. Power indicator

## REAR PANEL

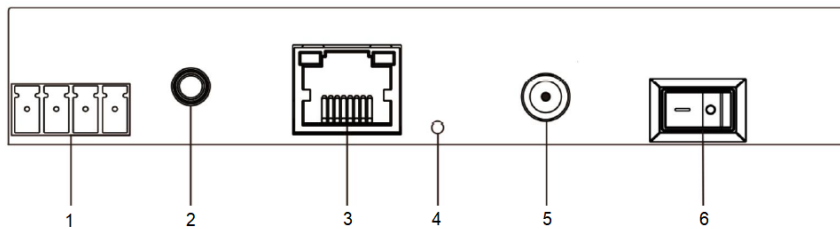

1. MIC input interface
2. Line input interface
3. Network interface
4. Reset
5. Power cord
6. Power switch

## CONNECTION DIAGRAM

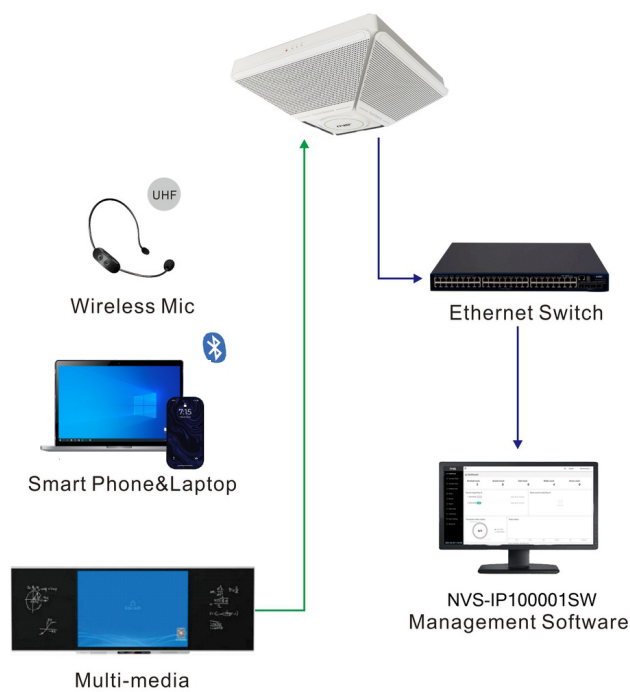

# 360 Tune Cast Smart Speaker

## INSTALLATION

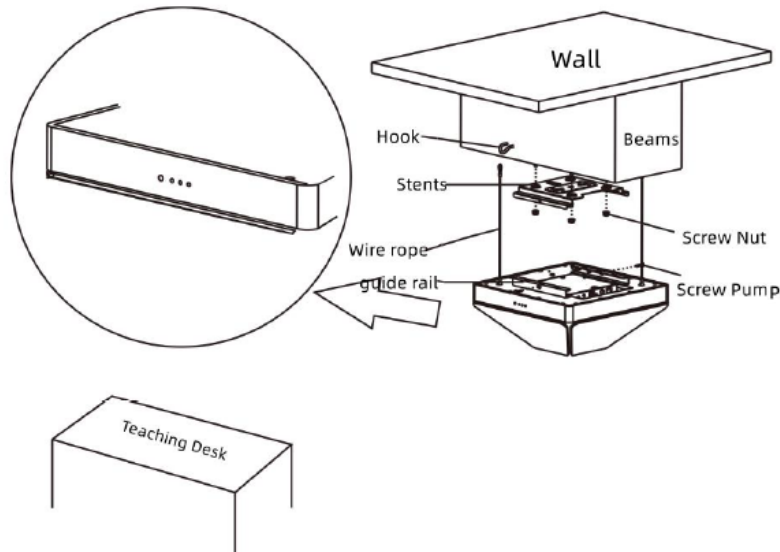

### Instructions:

1. Drive two expansion hooks and four expansion screws into the side and bottom of the beam-column, respectively (the equipment installed in the bracket determines where the expansion hooks should be, and the rope is stretched after the wire rope is gently hung to the expansion hook).
2. Tighten the bracket on the bottom of the beam-column with nuts (including spring washer and gasket), so that the bracket is fixed on the bottom of the beam-column.
3. Hang the steel wire rope on the expansion hook, then slide the equipment into the bracket through the open end of the guide rail on the equipment, and fix the equipment on the bracket with two M5\*12 cross screws and lock it.

Note: The indicator of the speaker must face the platform.

## ORDERING INFORMATION

Part Number	Description	Standard Quantity
NVS-IP100040SP	360 Tune Cast Smart Speaker	01